

Multiple tables for land parcels (POLIGONO A through V) with columns for number, area (M2), volume (V2), and coordinates. Includes a summary table for 'RESUMEN DE AREAS GENERALES' at the top center.

DESCRIPCION	M2	V2
AREA UTL	29,321.68	41,953.44
A VERED Y EL D.C.		
PORCION 1	3,914.20	5,600.44
PORCION 2	873.60	1,249.95
AREA DE CIRCUIT	54,825.81	72,556.83
NUMERO DE LOTE	229	
AREA TOTAL A URB.	49,602.087 M2	70,970.67 V2

ESTACION	DISTANCIA	RUMBO	CLAVE
M1 M2	41.79	S 6421'19" W	CF
M2 M2A	29.31	S 541'42" W	CF
M2A M2B	104.88	N 7043'40" W	CF
M2B M2C	68.48	S 1941'09" W	CF
M2C M-B	421.61	N 7043'40" W	M.O.
M-B M67	5.28	N 5243'57" E	CF
M67 M68	16.95	S 5445'47" E	CF
M68 M69	11.63	N 6742'07" E	CF
M69 M70	19.71	N 5440'12" E	CF
M70 M7A	32.90	N 5042'37" E	CF
M7A M8A	137.54	S 7043'40" E	CF
M8A M89	70.09	N 3143'57" E	CF
M89 M90	46.34	S 6043'21" E	CF
M90 M91	57.32	S 7043'39" E	CF
M91 M1	202.08	S 7044'07" E	CF
AREA = 49602.087 M2 = 70970.666 VR2			
Propietario: AREA PARCELADA			



Tables for 'DERECHO DE VIA = 16.00' and 'SECCION CALLEJON CHUPADEROS' with columns for area, type (ACERA, ARRIBATE, RODAJE), and other specifications.

FINCA PROCAVIA

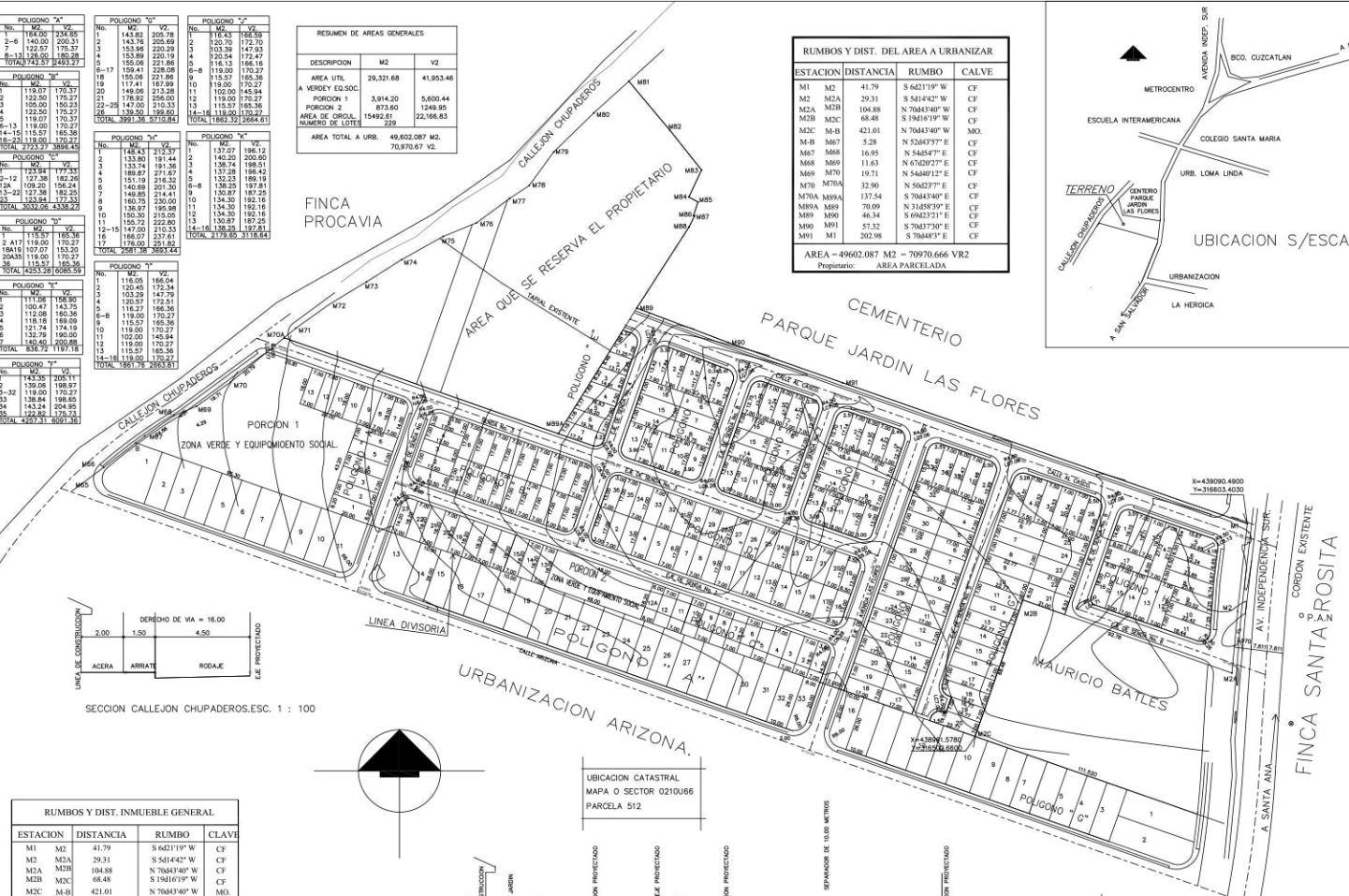

SECCION CALLEJON CHUPADEROS, ESC. 1 : 100



ESTACION	DISTANCIA	RUMBO	CLAVE
M1 M2	41.79	S 6421'19" W	CF
M2 M2A	29.31	S 541'42" W	CF
M2A M2B	104.88	N 7043'40" W	CF
M2B M2C	68.48	S 1941'09" W	CF
M2C M-B	421.61	N 7043'40" W	M.O.
M-B M67	5.28	N 5243'57" E	CF
M67 M68	16.95	S 5445'47" E	CF
M68 M69	11.63	N 6742'07" E	CF
M69 M70	19.71	N 5440'12" E	CF
M70 M71	40.05	N 5440'12" E	CF
M71 M72	20.01	N 5440'12" E	CF
M72 M73	20.10	N 5845'39" E	CF
M73 M74	19.69	N 5743'79" E	CF
M74 M75	22.43	N 6404'09" E	CF
M75 M76	17.16	N 6743'51" E	CF
M76 M77	19.37	N 5344'19" E	CF
M77 M78	11.16	N 5642'77" E	CF
M78 M79	19.72	N 3641'12" E	CF
M79 M80	26.50	N 4545'17" E	CF
M80 M81	22.29	N 4745'02" E	CF
M81 M82	30.19	S 3945'09" E	M.U.
M82 M83	24.17	S 3628'17" E	M.U.
M83 M84	14.10	S 2548'30" W	M.U.
M84 M85	4.90	S 6142'32" E	M.U.
M85 M86	6.83	S 1841'45" W	M.U.
M86 M87	6.83	N 8945'09" E	M.U.
M87 M88	6.06	S 2641'19" W	M.U.
M88 M89	45.60	S 3340'23" W	M.U.
M89 M90	46.34	S 6043'21" E	CF
M90 M91	57.32	S 7043'39" E	CF
M91 M1	202.08	S 7044'07" E	CF
AREA = 64,340.54 M2 = 92,058.44 VR2			

ESTACION	DISTANCIA	RUMBO	CLAVE
M81 M82	30.19	S 3945'09" E	M.U.
M82 M83	24.17	S 3628'17" E	M.U.
M83 M84	14.10	S 2548'30" W	M.U.
M84 M85	4.90	S 6142'32" E	M.U.
M85 M86	6.83	S 1841'45" W	M.U.
M86 M87	6.83	N 8945'09" E	M.U.
M87 M88	6.06	S 2641'19" W	M.U.
M88 M89	45.60	S 3340'23" W	M.U.
M89 M89A	70.09	S 3143'57" W	CF
M89A M90A	137.54	N 7043'40" W	CF
M90A M71	7.15	N 9042'37" E	CF
M71 M72	20.01	N 5440'12" E	CF
M72 M73	20.10	N 5845'39" E	CF
M73 M74	19.69	N 5743'79" E	CF
M74 M75	22.43	N 6404'09" E	CF
M75 M76	17.16	N 6743'51" E	CF
M76 M77	19.37	N 5344'19" E	CF
M77 M78	11.16	N 5642'77" E	CF
M78 M79	19.72	N 3641'12" E	CF
M79 M80	26.50	N 4545'17" E	CF
M80 M81	22.29	N 4745'02" E	CF
AREA = 14738.453 M2 = 21067.778 VR2			
Propietario: AREA RESERVADA			



PROPIETARIO: AGUSTINA MENA ARIZ C/P TRINA MENA DE ESCALAN	UBICACION: AVENIDA INDEPENDENCIA SUR SANTA ANA
PRESENTA:	
AREA TOTAL 64,340.54 M2 92,058.44 V2	
FECHA: SEPTIEMBRE/2011	
ESCALA 1 : 1000	HOJA 1/3

FINCA SANTA ROSITA